



Batesville Community Education Foundation

BCEF

2023 Annual Campaign

Estimated Total Project Cost: \$333,404

The power  of community uniting for education.

Help BCEF build an OUTDOOR LEARNING COMPLEX at the Batesville Primary School.

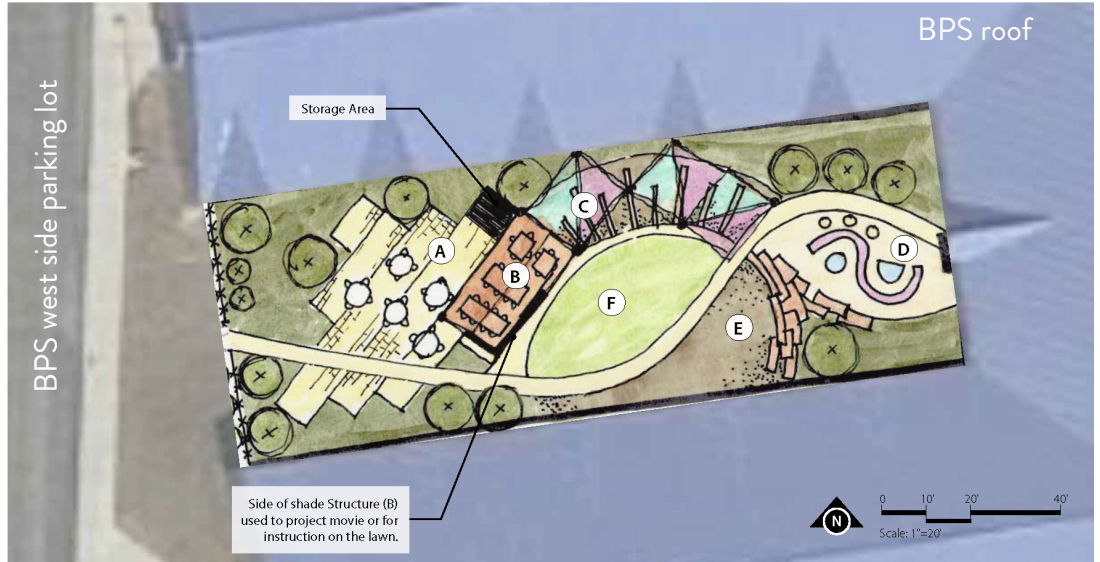
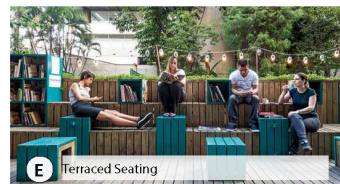

BATESVILLE PRIMARY SCHOOL
OUTDOOR LEARNING COMPLEX | CONCEPT PLAN



The Batesville Primary School (BPS) continues to have increased enrollment. With indoor space at a premium at a school where our youngest learners need room to move around and explore, the BCEF board of directors would like to meet this need by building an outdoor learning complex on the west side of the building. Our plans include three distinct learning spaces: an open-air gathering/classroom area (concrete and/or pavers) with seating near the school, a shade-covered seating area, and a separate, covered classroom structure farther out with supplemental seating on a patio. All areas would be connected by a green space with a winding sidewalk. A fence would safely secure the area from the parking lot. By providing BPS an additional, dedicated space outside that encourages creativity and personal connection with others in a fun, engaging, unplugged environment, BCEF hopes to give students the chance to LEARN EVERYWHERE.



Studies show that being outdoors helps students become:

- More engaged in learning
- More focused
- Mentally healthier
- More successful academically

Scan the QR code to see our video

Learn more

BPS teacher comments



Students need an opportunity to have a learning space outside the classroom walls. This will help to maintain excitement in the classroom to provide an enhanced learning environment.

Outdoor seating would be amazing. I like the idea of benches around the whiteboard, so teachers could teach outside and the idea of flexible seating options that students could then move around to work in small groups or with partners. I love this idea; students would really enjoy working outside!

If teachers could take a class or groups outside and teach them concepts in a different way, I think this would be great! There are so many lessons that can be taught without using a device and even perhaps using nature. Sometimes just a different learning environment for kids is the "attention-getter" they may need.

MAJOR GIFTS

HILLENBRAND

Partnership with Possibility Grant

through the



**The Fred and Jolene Rockwood
Family Foundation**

CHECK OUR WEBSITE FOR AN UPDATED LIST
AS THE CAMPAIGN CONTINUES

THANK YOU



For donating the time and talent to create
our project storyboard

2023 Annual Campaign Donation Form

Estimated Total Project Cost: \$333,404

Donations are unrestricted & support the BPS outdoor learning complex and other BCEF vital needs.

2 DONATION OPTIONS:

1) **ONLINE** with credit/debit card, Venmo,
Paypal, ACH

**ONE-TIME GIFT OR MONTHLY GIVING
OPTIONS AVAILABLE**



Scan QR code with
your smart phone
or visit website
listed below to
donate online

2) **CHECK**

Make payable to BCEF

Total enclosed: _____



DONOR INFORMATION

Name: _____

Mailing Address: _____

City, State, Zip: _____

Phone: _____

Email: _____

All donors are added to our Friends of BCEF list.

RETURN FORM & DONATION TO BCEF, P.O. BOX 121, BATESVILLE, IN 47006

Questions? Contact BCEF Executive Director Anne Wilson at awilson@batesville.k12.in.us.

BatesvilleEducationFoundation.org